



# NOVA



**NOVA 4100  
POND & FOUNTAIN PUMP**

# NOVA 4100

## POND & FOUNTAIN PUMPS



### TECHNICAL DATA

**Operating range:** from 1 to 3600gpm with head up to 31feet..

**Pumped liquid temperature range:** from +32 °F (0°C) to +95 °F (35°C).

**Max. Submersion:** 22ft

**Protection class:** IP 68.

**Insulation class:** F.

**Installation:** Vertical or horizontal.

**Standard power input:** single-phase 1 x 110-127 V~ 60 Hz.  
single-phase 1 x 220-240 V~ 60 Hz.

**Pumped liquid:** clean water, without fibres and with particles with maximum diam. 0.393" (10 mm).

### APPLICATIONS

**Submersible pumps specifically designed for the recirculation of water in ponds, to create waterfalls and water features.**

Suitable for continuous operation.

### CONSTRUCTION FEATURES OF THE PUMP

Hydro resistant technopolymer pump body, wear-free impellers, cover, and suction grid. Corrosion and oxidation resistant materials.

### CONSTRUCTION FEATURES OF THE MOTOR

Submersible type continuous duty asynchronous motor.

Thermal overload protection.

Wear-resistant motor shaft.

### MATERIALS

N°	PARTS*	MATERIALS
1	PUMP BODY	TECHNOPOLYMER
2	TOP BODY	TECHNOPOLYMER
3	PUMP BASE	TECHNOPOLYMER
4	IMPELLER	TECHNOPOLYMER
5	'O' RING	NBR 70
6	SPACER BODY	PP 30% GF NAT GRADE 6
7	ROTOR SHAFT	AISI 416 STAINLESS STEEL NI EN 10088-1 X12CRS13
8	UPPER MOTOR CASING	CAST ALUMINUM
9	'O' RING	NBR 70
10	TRIPLE LIP SEAL	NBR 70
11	LOWER MOTOR CASING	CAST ALUMINUM
12	LOCK NUT	STAINLESS STEEL 316 DIN 982

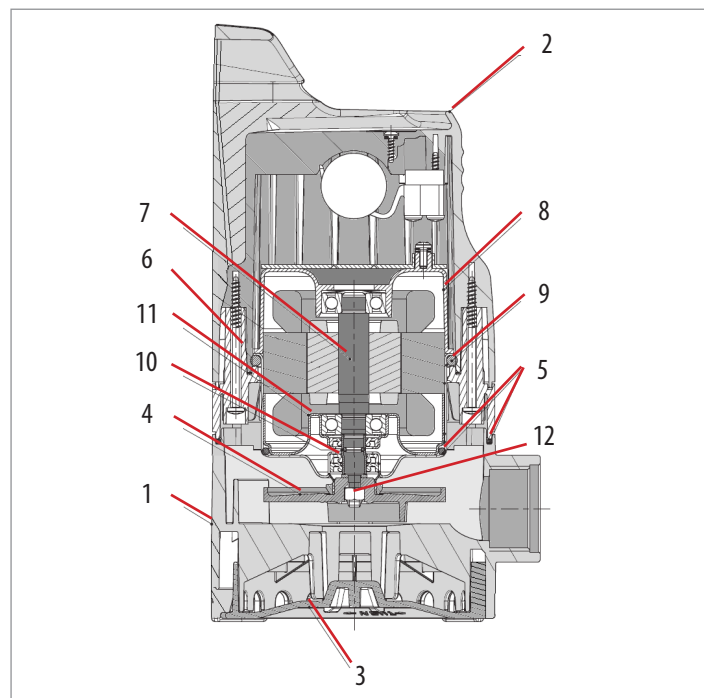

\* In contact with liquid

# NOVA 4100 - POND & FOUNTAIN PUMPS

Pumped liquid temperature range: from +32 °F to +95°F

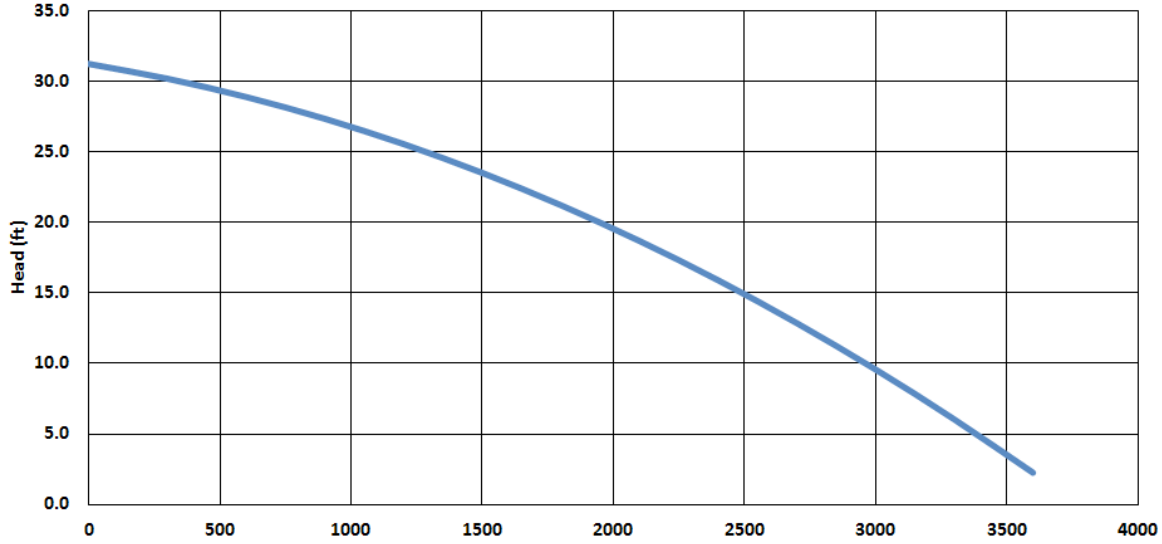

MODEL	Q=gph	0	300	600	900	1200	1500	1800	2100	2400	2700	3000	3300	3600
NOVA 4100	H (ft)	31.2	30.2	28.9	27.3	25.6	23.5	21.2	18.7	15.9	12.9	9.6	6.0	2.3

MODEL	POWER INPUT 60 Hz	P1 Max		P2		In A	Max Submersion
		HP	W	HP	W		
NOVA 4100	1 x 115~	0.9	670	0.5	380	7.1	22 ft
NOVA 4100	1 x 230~	0.9	670	0.5	380	3.2	22 ft

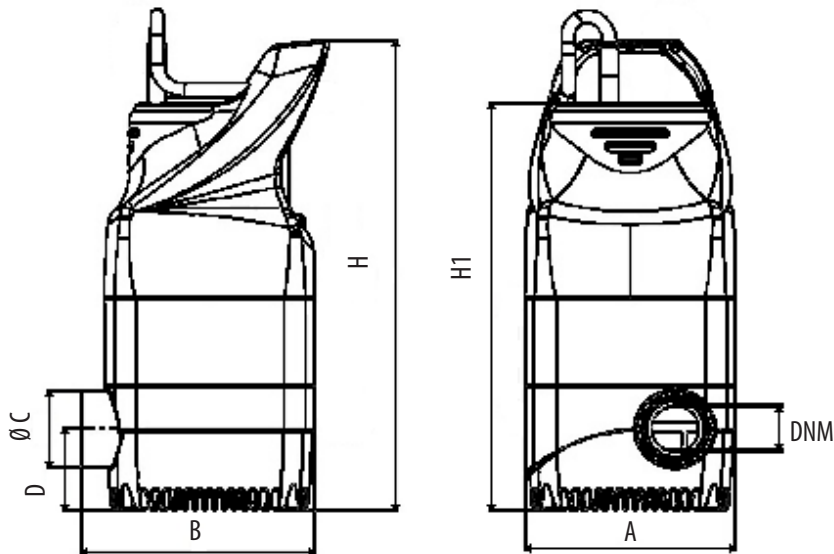

MODEL	A	B	ØC	D	H	H1	DNM GAS	PACKING DIMENSIONS			CABLE LENGHT	WEIGHT lbs	PALLET QTY
								L	B	H			
NOVA 4100 16'	5.512	6.102	2.087	2.205	12.795	11.024	1" ¼	7.598	7.598	14.764	16 ft	14.8	72
NOVA 4100 100'	5.512	6.102	2.087	2.205	12.795	11.024	1" ¼	7.598	7.598	14.764	100 ft	15.9	72